



CHATTERTON | REES



347 Lillie Road

, London, SW6 7PA

Asking price £799,950

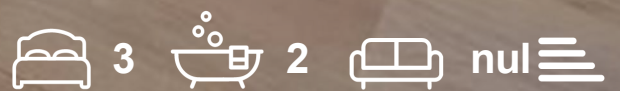

347 Lillie Road



Description

A stunning and rare Freehold three bedroom, Maisonette with its own front door and over 1000 sqft of living space. The flat has been finished to a very high standard throughout with great storage space.

Entering through your own private front door, this flat offers three double bedrooms with a modern and functional kitchen which opens into the vast living space with three large windows letting in plenty of light. The flat benefits from a pretty flat roof space which has lovely green views over the local park.

Walking distance to Parsons Green, Fulham Broadway and Barons Court underground stations this flat has great transport links as well as being close to all the cafes, shops and restaurants locally.

- 3 bedrooms
- Private entrance
- Over 1000 sqft
- Terrace
- Freehold
- Good condition





Floor Plan

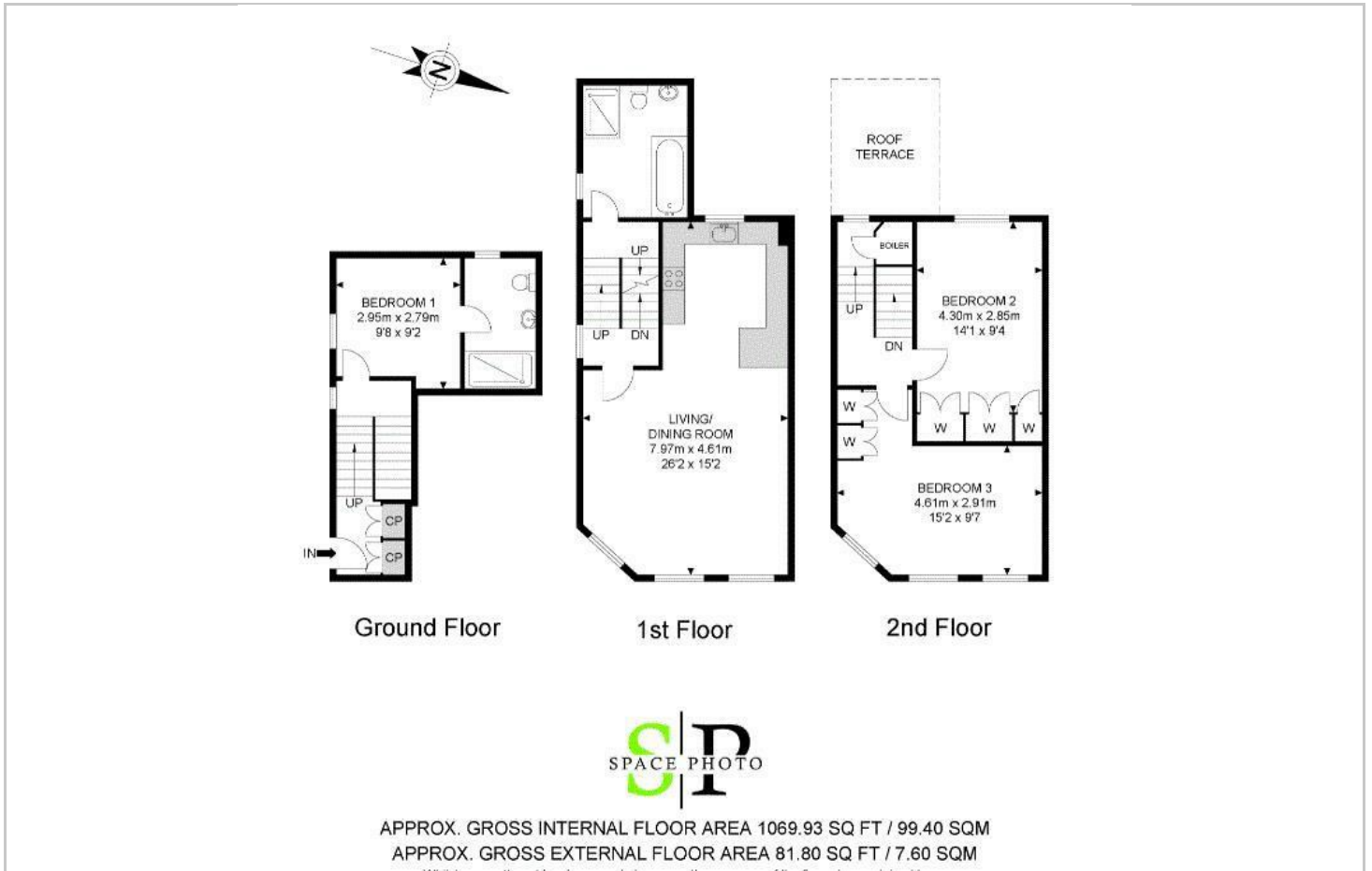

Area Map

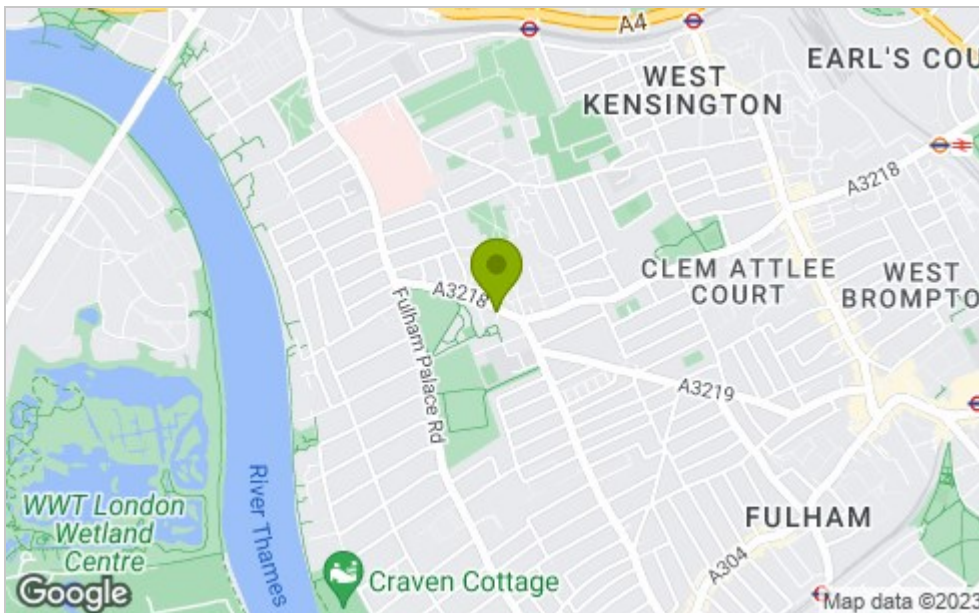

Viewing

Please contact our Chatterton Rees Office on 020 3780 0580 if you wish to arrange a viewing appointment for this property or require further information.

These particulars, whilst believed to be accurate are set out as a general outline only for guidance and do not constitute any part of an offer or contract. Intending purchasers should not rely on them as statements of representation of fact, but must satisfy themselves by inspection or otherwise as to their accuracy. No person in this firm's employment has the authority to make or give any representation or warranty in respect of the property.

Energy Efficiency Graph

